



## Duty Roller Conveyor with Tangential Drive



The GURA-Medium Duty Roller Conveyor is designed to convey boxes, steel and plastic containers.

This roller conveyor is mainly used in in-house transport with picking, sorting and distribution systems. It is also used for the transport of workpiece carriers and to connect machine and assembly stations. This conveyor is designed for a safe transport of goods up to a max. load of 60 daN/m in a simple and economical way. The zinc-plated steel rollers are firmly put into the frame and equipped with a plastic single sprocket  $Z = 11 \frac{1}{2} \times 5/16$ .

The maintenance-free rollers come with a serial permanent lubrication. The speed (v) is from 0.1 to 0.5 m/s. With a roller pitch of 100 mm the reference value for the carrying capacity is approximately 30 daN/m for boxes and approximately 60 daN/m for steel and plastic containers.

The accumulation pressure with a single friction drive is approximately 7 % of the good to be conveyed, and with a double friction drive it is approximately 14 %. To separate goods further we provide electropneumatically stops and acceleration lines.

For troublefree operation you only need an oil and grease-free environment. As an option we offer enamelled steel profiles.

To upgrade your system a large-scale of ancillary equipment is provided, as well as controls.

### GURA Roller Conveyor

- Bed widths: 300, 400, 450, 500, 600, 700 mm
- Roller pitches: 55, 75, 100, 125 mm
- Steel rollers:  $\varnothing 50$  mm, zinc-plated
- Drive: 3x230/400 volts, gear motor with intermediate gear, max. v = approx. 0.1 - 0.5 m/s
- Length: approx. 5m / with a strain of 60daN/m per drive unit
- Customized widths possible
- Profile: Zinc-plated steel (SV), optional we offer enamelled steel profiles (SL).
- Zinc-plated H-type supports and mountings
- Our complete system program includes straight lines, curves, merges and further components
- Ancillary equipment: guide rail, height and width adjustable, H-type supports, end stops

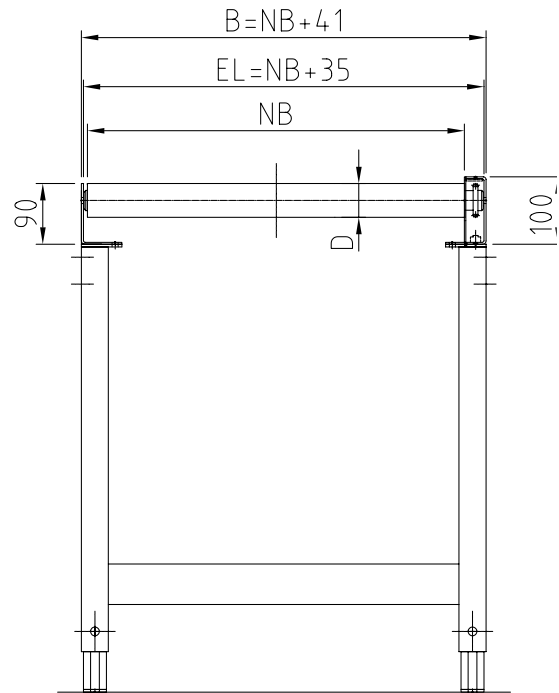
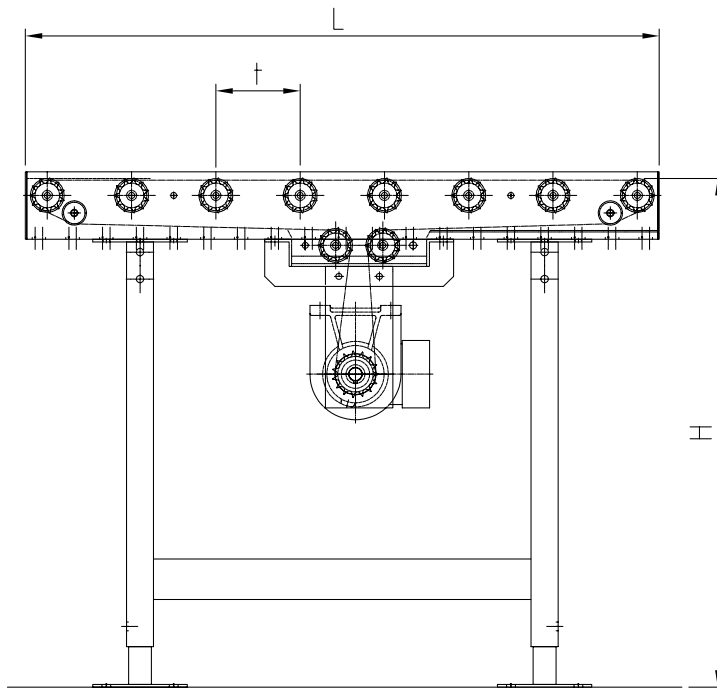

**Accumulation Roller Conveyor, Friction Drive**

Series	NB [mm]	t [mm]	L [mm]	Rollers D [mm]	Profile	v [m/s]	Capacity* [daN/m]
53100	300, 400 450, 500 600, 700	55, 75, 100, 150	length of segment max. 3000 mm as a multiple of t	50x1.5 SV	profile U30x100x60x3, SV and L90x60x3, SV	0.1 - 0.5	1 - 60

**Accumulation Roller Conveyor, Double Friction Drive**

Series	NB [mm]	t [mm]	L [mm]	Rollers D [mm]	Profile	v [m/s]	Capacity* [daN/m]
53200	300, 400 450, 500 600, 700	55, 75, 100, 150	length of segment max. 3000 mm as a multiple of t	50x1.5 SV	profile U30x100x60x3, SV and L90x60x3, SV	0.1 - 0.5	1 - 60

**Powered Accumulation Roller Conveyor**

Series	NB [mm]	t [mm]	L [mm]	Rollers D [mm]	Profile	v [m/s]	Capacity* [daN/m]
53300	300, 400 450, 500 600, 700	55, 75, 100, 150	length of segment max. 3000 mm as a multiple of t	50x1.5 SV	profile U30x100x60x3, SV and L90x60x3, SV	0.1 - 0.5	1 - 60

**Example Order: 53100 100 400 3000** = Accumulation Roller Conveyor, Friction Drive

- 53100** = Series no.
- 100** = Roller pitch t [mm]
- 400** = Nominal width NB [mm]
- 3000** = Length L [mm]

**Ancillary Equipment:**

Series	NB [mm]	Description
F5042	300 - 700	support, adjustment range H= +- 50 mm
F3002	300 - 700	support with swivel joint, adjustment range H= +- 50 mm
59930		guide rail, at both sides, SV-tube
56950	300 - 700	pneumatic sword-shaped stop (with friction drive only)
59910		light barrier and reflector holder