

Turntable with Chain Conveyor

The GURA Turntable of series 61300 and 61400 with a built-on powered chain conveyor is mainly used to turn pallets and boxes about a specified angle where it is necessary.

This conveyor is designed for a safe transport of goods up to a max. load of 2000 daN.

When rotating up to 270° the power supply of the upper part is implemented via a cable loop. In case of further rotation the turntable has to be fitted with a slip ring. The chain conveyor built on the turntable always has three lanes to guarantee the optimum transfer of pallets

to the other conveyors. The pre-stressed backlash-free turntable is mounted on a live ring and powered by a friction wheel (series 61300) or chain and pinion (series 61400). The positioning is implemented by adjustable electronic signal transmitters at the base frame. The turntable with friction drive is designed for low overall heights (from 350 to 450 mm). Additional system components are available too.

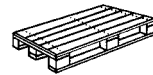

GURA Turntable

- Working widths NB: 900,1100 mm
- Customized widths possible
- Turntable diameter = NB +700 mm
- Conveyor chain: 5/8 x 3/8 Duplex, 3 lanes
- U-shaped profile: 60x100x60x4 mm, enamelled
- Durable supports with adjustable feet (M24), enamelled
- Standard conveyor height: 500 +30 mm, special heights on request
- Standard conveying speed
 $v = 0.2 \text{ m/s}$
- Gear motor: 230/400 V, 50Hz

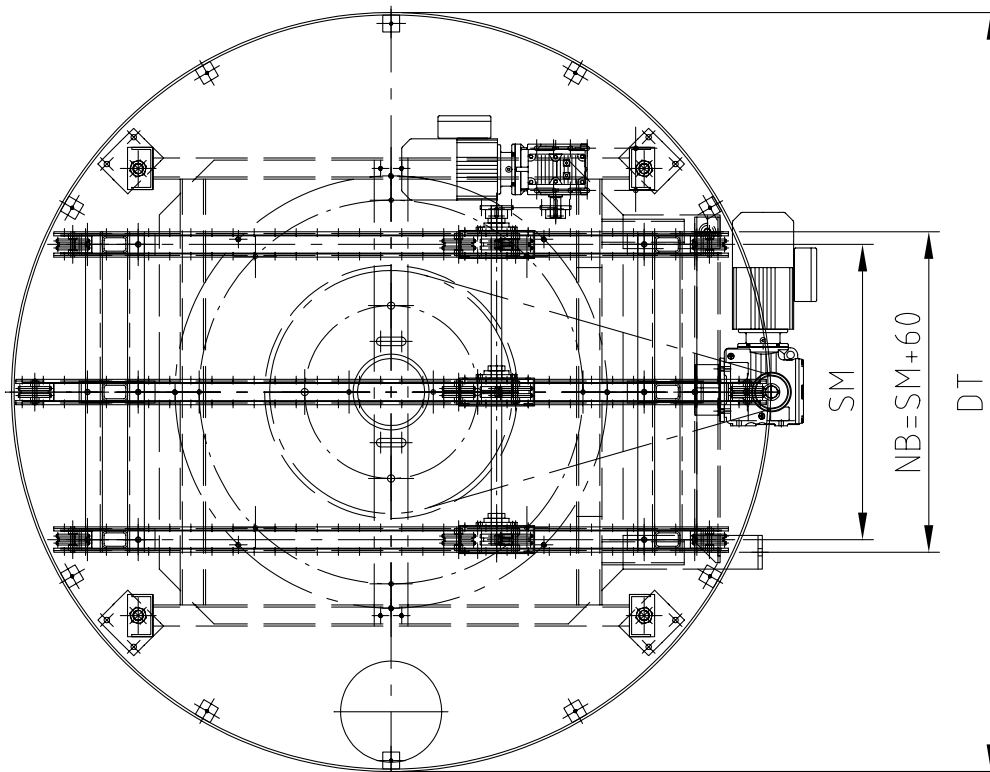

Turntable with Chain Conveyor, Friction Drive

| Series | NB [mm] | DT [mm] | Goods | H [mm] | v [m/s] | SM [mm] | Capacity* [daN/Pallet] |
|--------|---------|---------|---|----------|---------|---------|------------------------|
| 61310 | 1300 | 2000 | Euro pallet, transverse transfer | | | 1100 | |
| 61320 | 900 | 1600 | Euro pallet, longitudinal transport | | | 700 | |
| 61330 | 1300 | 2000 | industrial pallet, transverse transfer | min. 350 | 0.2 | 1100 | max. 2000 |
| 61340 | 1100 | 1800 | industrial pallet, longitudinal transport | | | 700 | |
| 61350 | | | customized edition | | | | |

Rotational speed 90 degrees / 5s

Turntable with Chain Conveyor, Chain Drive

| Series | NB [mm] | DT [mm] | Goods | H [mm] | v [m/s] | SM [mm] | Capacity* [daN/Pallet] |
|--------|---------|---------|---|----------|---------|---------|------------------------|
| 61410 | 1300 | 2000 | Euro pallet, transverse transfer | | | 1100 | |
| 61420 | 900 | 1600 | Euro pallet, longitudinal transport | | | 700 | |
| 61430 | 1300 | 2000 | industrial pallet, transverse transfer | min. 450 | 0.2 | 1100 | max. 2000 |
| 61440 | 1100 | 1800 | industrial pallet, longitudinal transport | | | 700 | |
| 61450 | | | customized edition | | | | |

Rotational speed 90 degrees / 5s

* Benchmarks
 Mandatory values on request.

Example order: 61310 – 1300 – 2000 = Turntable with Chain Conveyor for Euro Pallets, Transverse Transfer

- 61310 = Series no.
- 1300 = Diameter Turntable (DT) [mm]
- 2000 = Nominal width (NB) [mm]

Ancillary Equipment:

| Series | Description |
|--------|------------------------------------|
| 64900 | buffer, running meter |
| 64940 | light barrier and reflector holder |