



Heavy Load Carriers Moving Loads Easily



The conveyor roller of series 92000 is completely made of steel. Only the sealings are made of plastic. Especially regarding to economical reasons it can be used in many areas of the conveying technology. The durable construction is designed for severe conditions. The construction of the ball bearings is especially designed for the needs of the conveying technology. They are maintenance-free and have excellent performance with heavy loads.

GURA Steel Conveyor Roller Series 92000

Bearings:	steel roller floor	Ø 30 mm = 160 daN/roller *
	ball bearing	Ø 40 mm = 100 daN/roller *
	zinc-plated (SV)	Ø 50 mm = 150 daN/roller *
		Ø 60 mm = 150 daN/roller *
		Ø 80 mm = 200 daN/roller *
		Ø 89 mm = 450 daN/roller *
Tubes:	steel tube, bright (SB)	Ø 40, 50, 60, 80, und 89 mm
	steel tube, zinc-plated (SV)	
	steel tube, stainless steel (SN)	
	aluminium tube (AL)	
Axles:	bright, zinc-plated and stainless steel	Ø 6 - 20 mm
Axle ends:	external thread (AG)	Ø 6, 8, 10, 12 mm
	wrench flat (SW)	Ø 8, 10, 12, 17, 20 mm
	internal thread (IG)	Ø 12, 17, 20 mm
	spring loaded axle (FA)	Ø 6, 8, 10, 12 mm
	hexagon spring loaded axle (FA)	11 SK

* The carrying capacities listed above refer to the bearing assemblies per roller.

Depending on the design the carrying capacities of the tube and axle may be lower than these values.

If desired we can calculate the carrying capacity of your roller.

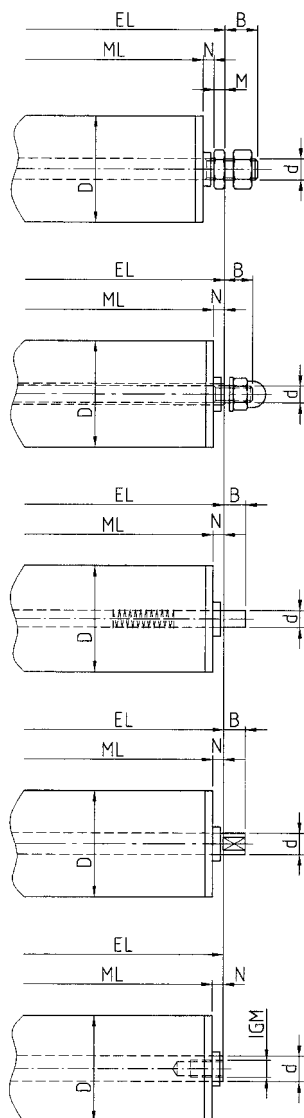

Axle Fixings	Axle Code	d [mm]	M [mm]	Axial Play [mm]	B [mm]
External Thread Axle	AG 6	6	3.2	3	10
	AG 8	8	4	3	11
	AG 10	10	5	3	15
	AG 12	12	6	3	18
Spacer Tube with External Thread Axle	DR 8 AG 6	6		3	10
	DR 10 AG 8	8		3	11
Spring Loaded Axle	FA 6	6		3	10
	FA 8	8		3	10
	FA 10	10		3	10
	FA 11 SK	11		3	10
	FA 12	12		3	10
Wrench Flat Axle	10 SW 8	10		3	10
	12 SW 10	12		3	10
	17 SW 13	17		3	12
	20 SW 15	20		3	15
Internal Thread Axle	12 IG M 8x15	12		3	
	17 IG M 10x20	17		3	
	20 IG M 12x25	20		3	

Series	Bearing Material	Tube Dimension [DxW]	Tube Material	Possible Axle Diameter [d]	Axle Material	Hub Width N [mm]	Max. Capacity of Bearing per Roller [daN]
92300	SV	30x1.5	SV	6, 8, 10		4	60
92400	SV	40x1.5	SB, SV	6, 8, 10, 12, 11 SK		4	100
92500	SV	50x1.5	SB, SV	8, 10, 12, 11 SK		4	150
92550	SV	50x1.5	SB, SV	8, 10, 12, 11 SK	SB	6.5	200
92600	SV	60x2	SB, SV	8, 10, 12, 11 SK	SV	4	150
92650	SV	60x2	SB, SV	10, 12, 11 SK	SN	6.5	200
92800	SV	80x2	SB, SV	10, 12, 11 SK		6.5	200
92850	SV	80x2	SB, SV	17, 20		5.5	200
92900	SV	89x3	SB, SV	17, 20		5.5	450

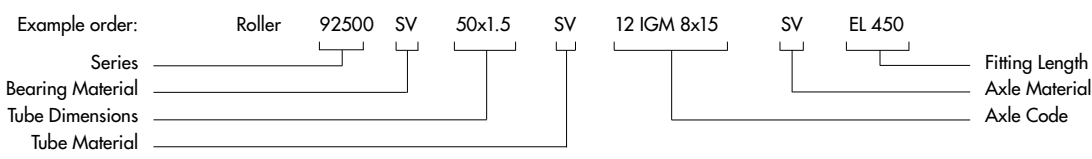

Engineering changes excepted.