



GURA Medium Duty Gravity Roller Conveyor



The GURA Medium Duty Gravity Roller Conveyor is designed to convey boxes, steel and plastic containers. This gravity roller conveyor is mainly used for the in-house transport with picking, sorting and distribution systems. It is also used for the transport of workpiece carriers and to connect machine and assembly stations.

This roller conveyor is designed for a safe transport of goods up to a max. load of 60 daN/m in a simple and economical way.

You can choose between zinc-plated steel rollers with spring loaded axles or internal thread axles. With a spring loaded axle and a roller pitch of 100 mm the reference value for the carrying capacity is approximately 30 daN/m for boxes and approximately 60 daN/m for steel and plastic containers.

With an internal thread axle and a roller pitch of 100 mm the reference value for the carrying capacity is approximately 30 daN/m for boxes and approximately up to 200 daN/m for steel and plastic containers.

As an option we offer enamelled steel profiles.

The steel profiles are sealed with a black plastic cover (PP) over the whole length. It can be used as a cable or compressed-air piping channel.

On request gaps between the rollers in the workplace sectors can be covered.

To upgrade your system a large-scale of ancillary equipment is provided, as well as controls.

GURA Medium Duty Gravity Roller Conveyor

- Bed widths: 300, 400, 450, 500, 600, 700 mm
- Roller pitches: 55, 75, 100, 150 mm
- Steel conveyor rollers: 50 / 60 mm, zinc-plated
- Customized lengths and widths on request
- Conveyor profile: zinc-plated steel (SV); enamelled version (SL) on request
- Zinc-plated H-type supports and mountings
- Our complete system program includes straight lines, curves, merges and further components
- Ancillary equipment: guide rail, height and width adjustable, H-type supports, end stops

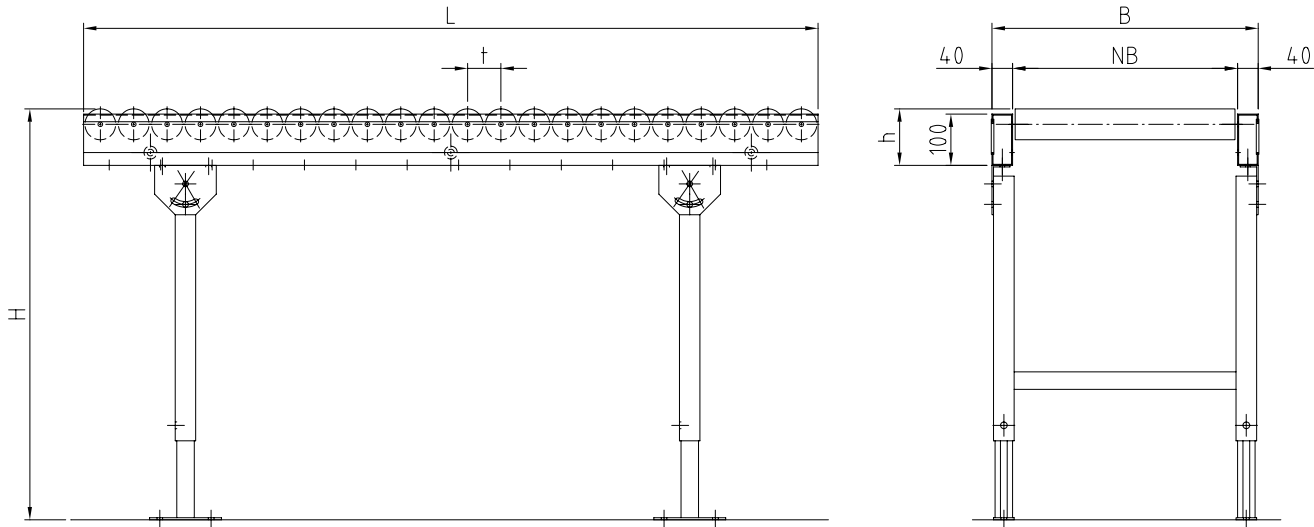

Medium Duty Gravity Roller Conveyor

Series	NB [mm]	t [mm]	L [mm]	Profile	Rollers D [mm]	Capacity* [daN]
51500	300, 400		length of segment	C40x100x40, SV, SL with plastic cover profile	50x1.5, SV with spring loaded axle 8 mm	1 - 60
	450, 500	55, 75,	max 3000 mm			
	600, 700	100, 150	as a multiple of t			
51510	300, 400		length of segment	C40x100x40, SV, SL with plastic cover profile	50x1.5, SV with internal thread axle 12 mm, internal thread M8	1 - 200
	450, 500	55, 75	max 3000 mm			
	600, 700	100, 150	as a multiple of t			
51600	300, 400		length of segment	C40x100x40, SV, SL with plastic cover profile	60x2.0, SV with spring loaded axle 8 mm	1 - 60
	450, 500	55, 75	max. 3000 mm			
	600, 700	100, 150	as a multiple of t			
51610	300, 400		length of segment	C40x100x40, SV, SL with plastic cover profile	60x2.0, SV with internal thread axle 12 mm, internal thread M8	1 - 200
	450, 500	55, 75,	max. 3000 mm			
	600, 700	100, 150	as a multiple of t			

Ancillary Equipment:

Series	NB [mm]	Description
F5042		support, range of adjustment H= +/- 50 mm
F3002	300 - 700	support with swivel joint, range of adjustment H= +/- 50 mm guide rail, at both sides SV-tube

Example order: 51500 – 100 – 400 – 3000 = Medium Duty Gravity Roller Conveyor

- 51500 = Series number
- 100 = Roller pitch t [mm]
- 400 = Nominal width NB [mm]
- 3000 = Track length L [mm]